

Professional Engineer Seal for the State of California, No. 12345, dated 12/31/2023.



Scale: 1/4" = 1'-0"

Scale: 1/4" = 1'-0"



Scale: 1/4" = 1'-0"

Notes:  
 1. All work shall conform to the 2019 International Building Code (IBC) and all applicable local codes.  
 2. The contractor shall be responsible for obtaining all necessary permits.  
 3. The owner shall provide access to all utility lines and easements.  
 4. The contractor shall maintain access to all adjacent properties at all times.  
 5. The contractor shall be responsible for the protection of all existing structures and utilities.  
 6. The contractor shall be responsible for the removal and disposal of all debris and materials.  
 7. The contractor shall be responsible for the cleanup and restoration of the site.  
 8. The contractor shall be responsible for the safety of all workers and the public.  
 9. The contractor shall be responsible for the completion of all work within the specified time frame.  
 10. The contractor shall be responsible for the payment of all bills and taxes.

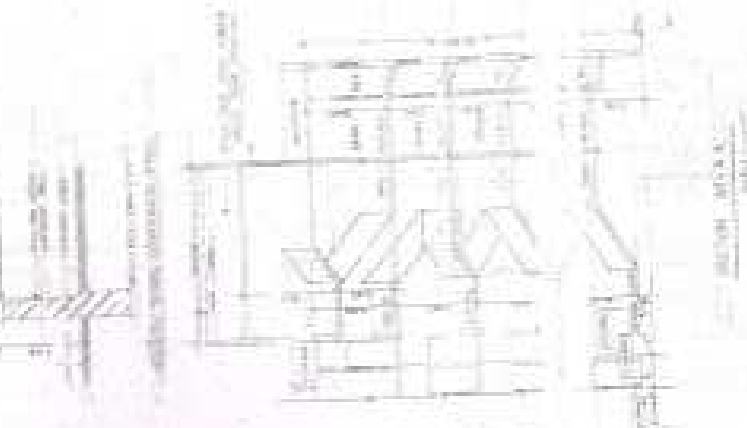

Scale: 1/4" = 1'-0"

Scale: 1/4" = 1'-0"